

Seal Design Variations

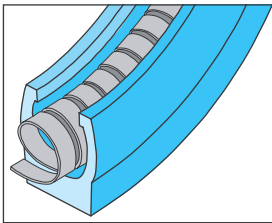

Saint-Gobain Performance Plastics offers the industry's most complete line of spring energiser configurations.

OmniSeal 103A Spring Design



OmniSeal 400A Spring Design

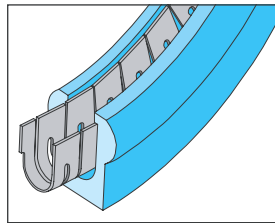

OmniSeal APS Spring Design

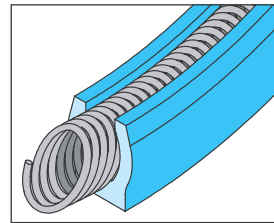

OmniSeal RPII Spring Design

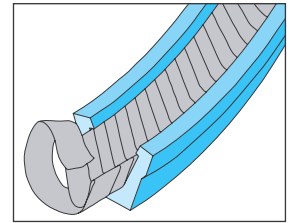

OmniSeal RACO 1100A Spring Design

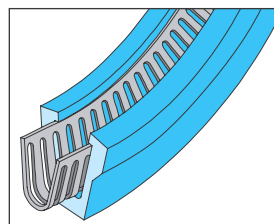

Skived Lip

All OmniSeal designs except OmniSeal RP II can be supplied with a sharp edge on either the I.D. or O.D. sealing lip. This edge provides a scraper/wiper action for sealing abrasive or viscous media. May also be used as an environmental excluder.



Extended Heel

OmniSeal seals can be supplied with an extended heel section for improved resistance to extrusion at high temperatures and/or high pressures. See page 14 for material selection guidance.

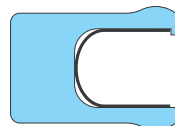

Flanged Heel

The flanged heel design is recommended for rotary/oscillatory shaft applications. The flange is clamped in the seal housing to prevent the seal from turning with the shaft.

